



TEGO™

C O N N E C T O R

**Never before in dialysis...
A closed system for Central Venous Catheters**



Protect the Catheter from Contamination

- The TEGO Connector creates a closed system, reducing manipulation of the catheter hub. Eliminates open catheter hubs.
- A high percentage of patients with long term Central Venous Catheters for chronic hemodialysis will develop a catheter related blood stream infection (CRBSI).
- CRBSI can result in increased complications for the patient as well as costly scheduling disruptions for the clinic.

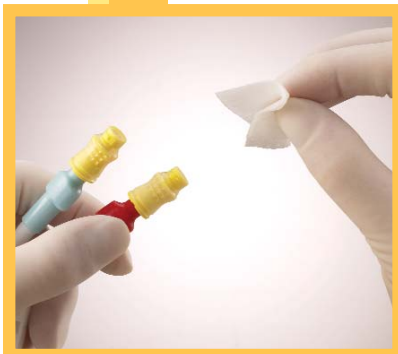

Functional Attributes

- The TEGO remains in place during the hemodialysis treatment. It permits flow rates through an unobstructed fluid path of greater than 600mL/min.
- The TEGO is ultra small and comfortable for the patient with the first and only non-abrasive exterior.
- When the TEGO is not activated the silicone seal completely closes the fluid path eliminating blood exposure during the dialysis procedure.

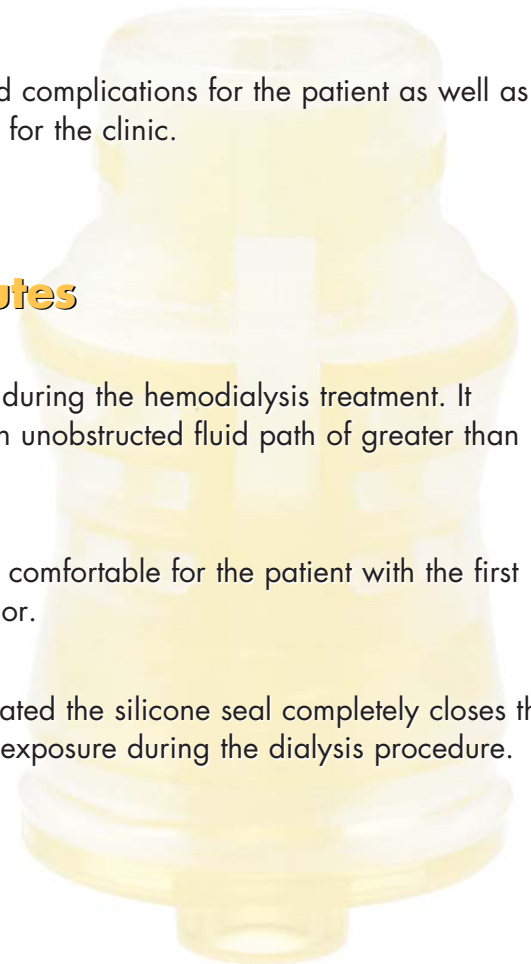

conTEGO (kon-ta'go); to cover, shield, protect, defend.

TEGO Connector

A Closed System for Central Venous Dialysis Catheters

DIRECTIONS FOR USE

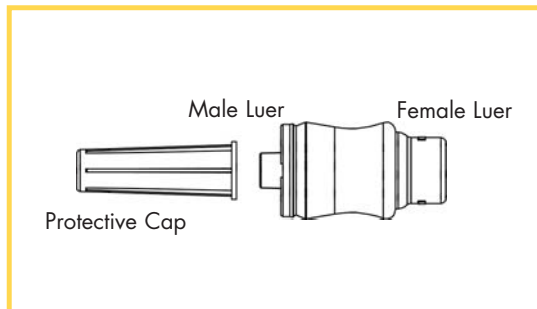

- 1) Using aseptic technique remove Tego Connector from package. Remove protective cap. Do not contaminate.

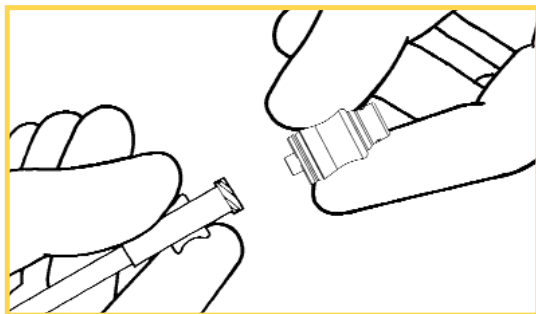

- 2) Attach male luer of Tego Connector to vascular access device.

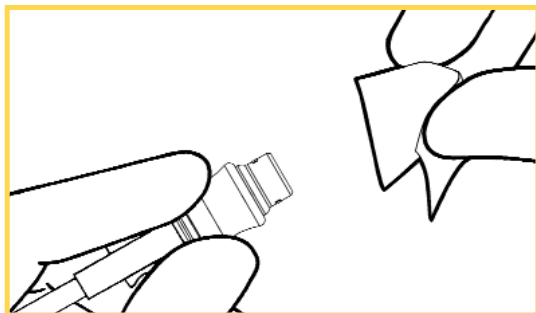

- 3) To access Tego Connector swab female luer with desired disinfectant in accordance with facility protocol.

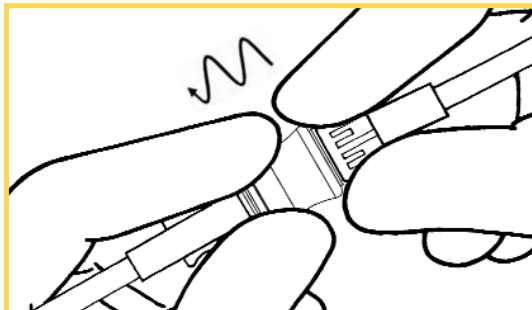

- 4) Attach a fully primed syringe or blood tubing to Tego Connector until secure.
- 5) Screw rotating collar of blood tubing onto Tego until it stops - do not over tighten.

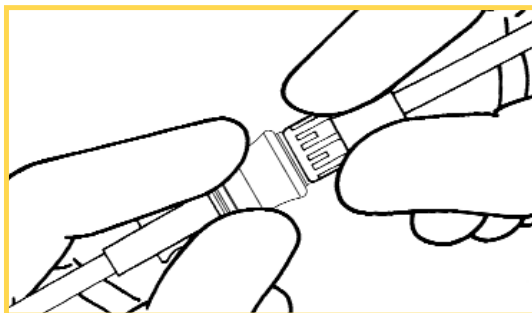

- 6) To disconnect from Tego Connector, grasp Tego and twist syringe or administration set away from Tego until loose.
- 7) Flush Tego Connector after each use in accordance with facility protocol.
- 8) For subsequent connections repeat steps three (3) through eight (8).

CAUTIONS:

- Do not cap Tego Connector. Device is closed.
- Do not use needles to access.
- Federal (USA) law restricts this device to sale by or on the order of a physician.



ICU Medical, Inc.

951 Calle Amanecer, San Clemente, CA 92673, U.S.A.

Tel: +1 949 366 2183 • www.icumed.com

US and Foreign Patents Pending

M1-1149 Rev.3